

Regularization Certificate for an Unauthorized Colony

①

From

**Competent Authority,
Cum-Deputy Director
Local Government Patiala.**

To **Sh. Rajesh Kant s/o Jagdish chander
Kharar.**

No. 1DDLG/ 45

Date 31/8/17,

With reference to your online application no. 484992 dated 5-2-2016 & 492321 dated 13.1.2017 the Regularization certificate for the colony, particular of which are given below, is hereby issued under section 4 of " The Punjab Laws (special provision) Act 2014" .

i)	Name of the Promoter(s)/ (Individual(s), company, Firm)	Rajesh Kant
ii)	Fathers Name (in case of individuals)	Jagdish chander
iii)	Name of colony (if any)	N.H.Homes,Kharar
iv)	Location (village with H.B.No)	H.B No 185
v)	Total area of colony in acres	2479.17 sq yard (0.51 acre)
vi)	Area sold (Acre-kanal-marla)	2101.39 sq yard (0.43 acre)
vii)	Area under common purpose (Acre-kanal-marla)	377.78 sq yd. (0.07 acres)
viii)	Saleable area still with the promoter (Acre-Kanal-marla)	525.34 sq yd. (0.10 acre)
ix)	No.of plots saleable as per layout plan	20 Residential ,including built up 15
x)	Khasra Nos.	Attached annexure A
xi)	Type of colony (Resi/comm/ind)	Residential
xii)	Year of establishment of colony	After 17-8-2007
xiii)	Detail of purchase of land as per registrered sale deed and registered agreement to sell by the Promoter B) Detail of the land purchased by the promoter.	Attached Annexure A

Detail of land sold through sale deed/Agreement to sell by the promoter.

As per Annexure B attached

xiv)	Saleable area with %age c) No. of saleable plots d) No. of commercial plots e)No. of industrial plots f) No. of plots under any other saleable use.	2101.39 sq yard (84.76%) 20 residential - - -
xv)	Area under Public purpose with % age	377.78 (15.24%)
xvi)	Public facilities provides in the colony; if any g) No. of parks/open .	

h) No. of schools with area	-
i) No. of community centre with area	-
j) STP	-
k) water works and OHSR	-
l) Dispensary / health centre	-
m) any other public use.	-
xvii) Area under roads with %age	377.78 sq yd (15.24%)
xviii) width of approach road	22'-0
xix) width of internal road(mention range of width i.e 20'-40' etc)	16-0
xx) Mode of payment received	Lum sum
xxi) Demand draft/Cash	Demand draft
xxii) Fees / charges received	Rs.525000.00
xxiii) In case of payment by	D.D no 728883 dated 13-1-17 and 671238 dated 5.2.2016
xxiv) Name of Drawee Bank	PNB

D.A/ Approved layout)

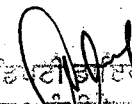
 ਡਿਪਟੀ ਕਮਿਸ਼ਨਰ
 ਕਮਿਸ਼ਨਰੀ ਆਫ਼ ਯੂਰਬਨ ਡਿਵੀਜ਼ਨ
 ਸ਼ਹਿਰੀ ਸੇਵਾ ਨਿਗਮ ਪਟਿਆਲਾ
 Competent Authority

Residential Fee	2479.17x5250x4%	Rs 520626.00
amount paid		Rs. 525000.00
Balance payable		Rs. 0.00

Payment Schedule 0.00

Sr.no	Installments	Amount	Interest 12% P.A	Total amount
1	1st installment within 180 days from date of approval	0.00	0.00	0.00
2	2nd installment within 360 days from date of approval	0.00	0.00	0.00
3	3rd installment within 540 days from date of approval	0.00	0.00	0.00
	Total	0.00	0.00	0.00

- Note:1) No separate notice shall be issued for the payment of installments.
- 2) Executive officer ,MC Kharar vide letter no. 558 dated 25-5-2017, 898 dated 27-7-17 had informed to this office that 100% fee had been deposited by the colonizer. Consequent of miscalculation if any additional amount is worked out as recoverable at any stage applicant shall be liable to pay the same within 15 days from the issue of demand notice deposit the same.
- 3) If any of the conditions of the policy of the government found violated the Regularization Certificate granted shall liable to be cancelled.
- 4) This Regularization Certificate is granted subject to the decision of C.W.P No 4018 of 2012 (. Gurdeep Kaur vs state of punjab & others) pending in the Hon'ble High Court.
- 5) That the certificate is issued as per the recommdation of Executive officer and STP Municipal Corporation Patiala

6)
That if subsequently any defect is found in ownership. Any other documents or any encroachment will found, owner/developer shall be liable for the same.



Competent Authority

This certificate is subject to the verification of the information and the bank draft submitted by the applicant. In case the information provided by the applicant is found false/ incorrect at any stage, the compounding of the offence shall stand withdrawn and penal action against the applicant shall be initiated.

Endst. No. 1DDLG/ 46.

Dated: 31/8/17.

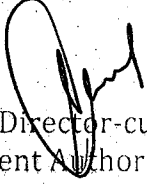
A copy of the above is forwarded to the Executive officer, Municipal Council Kharar with the direction if any discrepancy is noticed in this case the same will be informed to this office immediately.

Deputy Director-cum-
Competent Authority
Local Government patiala

**LAYOUT PLAN FOR
"NH HOMES"
AT WARD NO.-05 SECTOR-04
RAKBA - MUNDI KHARAR
TEHSIL - KHARAR
DISTT. S.A.S.NAGAR**

DETAIL OF AREA
 TOTAL LAND AREA= 22312.5 SQFT
 = 2479.17 SQYDS = 0.51 ACRES
 AREA UNDER PLOTS = 18912.50 SQFT
 = 2101.39 SQ. YDS (84.76%)
 AREA UNDER ROADS = 3400 SQFT
 = 377.78 SQ. YDS.(15.24%)
 AREA UNDER SOLD PLOTS = 14184.375 SQFT
 = 1576.05 SQ. YDS (75.00%)
 AREA UNDER UNSOLD PLOTS = 4728.125 SQFT
 = 525.34 SQ. YDS (25.00%)

Municipal Engineer
 Municipal Council
 KHARAR
 Submitted for Approval
 Ass't. Municipal Engineer
 Municipal Council
 Kharar

Executive Officer
 Municipal Council
 KHARAR

RESIDENTIAL PLOTS

No	PLOT NOS.	QTY	PLOT SIZE	AREA OF PLOT IN SQYDS	TOTAL AREA IN SQYDS
1-20	20	20	21'-3"x44'-6"	105.7	2101.39

SOLD AREA SHOWN AS [Solid Grey Box]
 BUILT UP AREA SHOWN AS [Hatched Box]

OWNER
 Rajesh Kaur
 108, 109, 110, 111, 112, 113, 114, 115, 116, 117, 118, 119, 120, 121, 122, 123, 124, 125, 126, 127, 128, 129, 130, 131, 132, 133, 134, 135, 136, 137, 138, 139, 140, 141, 142, 143, 144, 145, 146, 147, 148, 149, 150, 151, 152, 153, 154, 155, 156, 157, 158, 159, 160, 161, 162, 163, 164, 165, 166, 167, 168, 169, 170, 171, 172, 173, 174, 175, 176, 177, 178, 179, 180, 181, 182, 183, 184, 185, 186, 187, 188, 189, 190, 191, 192, 193, 194, 195, 196, 197, 198, 199, 200, 201, 202, 203, 204, 205, 206, 207, 208, 209, 210, 211, 212, 213, 214, 215, 216, 217, 218, 219, 220, 221, 222, 223, 224, 225, 226, 227, 228, 229, 230, 231, 232, 233, 234, 235, 236, 237, 238, 239, 240, 241, 242, 243, 244, 245, 246, 247, 248, 249, 250, 251, 252, 253, 254, 255, 256, 257, 258, 259, 260, 261, 262, 263, 264, 265, 266, 267, 268, 269, 270, 271, 272, 273, 274, 275, 276, 277, 278, 279, 280, 281, 282, 283, 284, 285, 286, 287, 288, 289, 290, 291, 292, 293, 294, 295, 296, 297, 298, 299, 300, 301, 302, 303, 304, 305, 306, 307, 308, 309, 310, 311, 312, 313, 314, 315, 316, 317, 318, 319, 320, 321, 322, 323, 324, 325, 326, 327, 328, 329, 330, 331, 332, 333, 334, 335, 336, 337, 338, 339, 340, 341, 342, 343, 344, 345, 346, 347, 348, 349, 350, 351, 352, 353, 354, 355, 356, 357, 358, 359, 360, 361, 362, 363, 364, 365, 366, 367, 368, 369, 370, 371, 372, 373, 374, 375, 376, 377, 378, 379, 380, 381, 382, 383, 384, 385, 386, 387, 388, 389, 390, 391, 392, 393, 394, 395, 396, 397, 398, 399, 400, 401, 402, 403, 404, 405, 406, 407, 408, 409, 410, 411, 412, 413, 414, 415, 416, 417, 418, 419, 420, 421, 422, 423, 424, 425, 426, 427, 428, 429, 430, 431, 432, 433, 434, 435, 436, 437, 438, 439, 440, 441, 442, 443, 444, 445, 446, 447, 448, 449, 450, 451, 452, 453, 454, 455, 456, 457, 458, 459, 460, 461, 462, 463, 464, 465, 466, 467, 468, 469, 470, 471, 472, 473, 474, 475, 476, 477, 478, 479, 480, 481, 482, 483, 484, 485, 486, 487, 488, 489, 490, 491, 492, 493, 494, 495, 496, 497, 498, 499, 500, 501, 502, 503, 504, 505, 506, 507, 508, 509, 510, 511, 512, 513, 514, 515, 516, 517, 518, 519, 520, 521, 522, 523, 524, 525, 526, 527, 528, 529, 530, 531, 532, 533, 534, 535, 536, 537, 538, 539, 540, 541, 542, 543, 544, 545, 546, 547, 548, 549, 550, 551, 552, 553, 554, 555, 556, 557, 558, 559, 560, 561, 562, 563, 564, 565, 566, 567, 568, 569, 570, 571, 572, 573, 574, 575, 576, 577, 578, 579, 580, 581, 582, 583, 584, 585, 586, 587, 588, 589, 590, 591, 592, 593, 594, 595, 596, 597, 598, 599, 600, 601, 602, 603, 604, 605, 606, 607, 608, 609, 610, 611, 612, 613, 614, 615, 616, 617, 618, 619, 620, 621, 622, 623, 624, 625, 626, 627, 628, 629, 630, 631, 632, 633, 634, 635, 636, 637, 638, 639, 640, 641, 642, 643, 644, 645, 646, 647, 648, 649, 650, 651, 652, 653, 654, 655, 656, 657, 658, 659, 660, 661, 662, 663, 664, 665, 666, 667, 668, 669, 670, 671, 672, 673, 674, 675, 676, 677, 678, 679, 680, 681, 682, 683, 684, 685, 686, 687, 688, 689, 690, 691, 692, 693, 694, 695, 696, 697, 698, 699, 700, 701, 702, 703, 704, 705, 706, 707, 708, 709, 710, 711, 712, 713, 714, 715, 716, 717, 718, 719, 720, 721, 722, 723, 724, 725, 726, 727, 728, 729, 730, 731, 732, 733, 734, 735, 736, 737, 738, 739, 740, 741, 742, 743, 744, 745, 746, 747, 748, 749, 750, 751, 752, 753, 754, 755, 756, 757, 758, 759, 760, 761, 762, 763, 764, 765, 766, 767, 768, 769, 770, 771, 772, 773, 774, 775, 776, 777, 778, 779, 780, 781, 782, 783, 784, 785, 786, 787, 788, 789, 790, 791, 792, 793, 794, 795, 796, 797, 798, 799, 800, 801, 802, 803, 804, 805, 806, 807, 808, 809, 810, 811, 812, 813, 814, 815, 816, 817, 818, 819, 820, 821, 822, 823, 824, 825, 826, 827, 828, 829, 830, 831, 832, 833, 834, 835, 836, 837, 838, 839, 840, 841, 842, 843, 844, 845, 846, 847, 848, 849, 850, 851, 852, 853, 854, 855, 856, 857, 858, 859, 860, 861, 862, 863, 864, 865, 866, 867, 868, 869, 870, 871, 872, 873, 874, 875, 876, 877, 878, 879, 880, 881, 882, 883, 884, 885, 886, 887, 888, 889, 890, 891, 892, 893, 894, 895, 896, 897, 898, 899, 900, 901, 902, 903, 904, 905, 906, 907, 908, 909, 910, 911, 912, 913, 914, 915, 916, 917, 918, 919, 920, 921, 922, 923, 924, 925, 926, 927, 928, 929, 930, 931, 932, 933, 934, 935, 936, 937, 938, 939, 940, 941, 942, 943, 944, 945, 946, 947, 948, 949, 950, 951, 952, 953, 954, 955, 956, 957, 958, 959, 960, 961, 962, 963, 964, 965, 966, 967, 968, 969, 970, 971, 972, 973, 974, 975, 976, 977, 978, 979, 980, 981, 982, 983, 984, 985, 986, 987, 988, 989, 990, 991, 992, 993, 994, 995, 996, 997, 998, 999, 1000

ARCHITECT
 Harpreet Kaur
 Architect, M.C.A., A
 Registered Professional Architect
 No. 108, 109, 110, 111, 112, 113, 114, 115, 116, 117, 118, 119, 120, 121, 122, 123, 124, 125, 126, 127, 128, 129, 130, 131, 132, 133, 134, 135, 136, 137, 138, 139, 140, 141, 142, 143, 144, 145, 146, 147, 148, 149, 150, 151, 152, 153, 154, 155, 156, 157, 158, 159, 160, 161, 162, 163, 164, 165, 166, 167, 168, 169, 170, 171, 172, 173, 174, 175, 176, 177, 178, 179, 180, 181, 182, 183, 184, 185, 186, 187, 188, 189, 190, 191, 192, 193, 194, 195, 196, 197, 198, 199, 200, 201, 202, 203, 204, 205, 206, 207, 208, 209, 210, 211, 212, 213, 214, 215, 216, 217, 218, 219, 220, 221, 222, 223, 224, 225, 226, 227, 228, 229, 230, 231, 232, 233, 234, 235, 236, 237, 238, 239, 240, 241, 242, 243, 244, 245, 246, 247, 248, 249, 250, 251, 252, 253, 254, 255, 256, 257, 258, 259, 260, 261, 262, 263, 264, 265, 266, 267, 268, 269, 270, 271, 272, 273, 274, 275, 276, 277, 278, 279, 280, 281, 282, 283, 284, 285, 286, 287, 288, 289, 290, 291, 292, 293, 294, 295, 296, 297, 298, 299, 300, 301, 302, 303, 304, 305, 306, 307, 308, 309, 310, 311, 312, 313, 314, 315, 316, 317, 318, 319, 320, 321, 322, 323, 324, 325, 326, 327, 328, 329, 330, 331, 332, 333, 334, 335, 336, 337, 338, 339, 340, 341, 342, 343, 344, 345, 346, 347, 348, 349, 350, 351, 352, 353, 354, 355, 356, 357, 358, 359, 360, 361, 362, 363, 364, 365, 366, 367, 368, 369, 370, 371, 372, 373, 374, 375, 376, 377, 378, 379, 380, 381, 382, 383, 384, 385, 386, 387, 388, 389, 390, 391, 392, 393, 394, 395, 396, 397, 398, 399, 400, 401, 402, 403, 404, 405, 406, 407, 408, 409, 410, 411, 412, 413, 414, 415, 416, 417, 418, 419, 420, 421, 422, 423, 424, 425, 426, 427, 428, 429, 430, 431, 432, 433, 434, 435, 436, 437, 438, 439, 440, 441, 442, 443, 444, 445, 446, 447, 448, 449, 450, 451, 452, 453, 454, 455, 456, 457, 458, 459, 460, 461, 462, 463, 464, 465, 466, 467, 468, 469, 470, 471, 472, 473, 474, 475, 476, 477, 478, 479, 480, 481, 482, 483, 484, 485, 486, 487, 488, 489, 490, 491, 492, 493, 494, 495, 496, 497, 498, 499, 500, 501, 502, 503, 504, 505, 506, 507, 508, 509, 510, 511, 512, 513, 514, 515, 516, 517, 518, 519, 520, 521, 522, 523, 524, 525, 526, 527, 528, 529, 530, 531, 532, 533, 534, 535, 536, 537, 538, 539, 540, 541, 542, 543, 544, 545, 546, 547, 548, 549, 550, 551, 552, 553, 554, 555, 556, 557, 558, 559, 560, 561, 562, 563, 564, 565, 566, 567, 568, 569, 570, 571, 572, 573, 574, 575, 576, 577, 578, 579, 580, 581, 582, 583, 584, 585, 586, 587, 588, 589, 590, 591, 592, 593, 594, 595, 596, 597, 598, 599, 600, 601, 602, 603, 604, 605, 606, 607, 608, 609, 610, 611, 612, 613, 614, 615, 616, 617, 618, 619, 620, 621, 622, 623, 624, 625, 626, 627, 628, 629, 630, 631, 632, 633, 634, 635, 636, 637, 638, 639, 640, 641, 642, 643, 644, 645, 646, 647, 648, 649, 650, 651, 652, 653, 654, 655, 656, 657, 658, 659, 660, 661, 662, 663, 664, 665, 666, 667, 668, 669, 670, 671, 672, 673, 674, 675, 676, 677, 678, 679, 680, 681, 682, 683, 684, 685, 686, 687, 688, 689, 690, 691, 692, 693, 694, 695, 696, 697, 698, 699, 700, 701, 702, 703, 704, 705, 706, 707, 708, 709, 710, 711, 712, 713, 714, 715, 716, 717, 718, 719, 720, 721, 722, 723, 724, 725, 726, 727, 728, 729, 730, 731, 732, 733, 734, 735, 736, 737, 738, 739, 740, 741, 742, 743, 744, 745, 746, 747, 748, 749, 750, 751, 752, 753, 754, 755, 756, 757, 758, 759, 760, 761, 762, 763, 764, 765, 766, 767, 768, 769, 770, 771, 772, 773, 774, 775, 776, 777, 778, 779, 780, 781, 782, 783, 784, 785, 786, 787, 788, 789, 790, 791, 792, 793, 794, 795, 796, 797, 798, 799, 800, 801, 802, 803, 804, 805, 806, 807, 808, 809, 810, 811, 812, 813, 814, 815, 816, 817, 818, 819, 820, 821, 822, 823, 824, 825, 826, 827, 828, 829, 830, 831, 832, 833, 834, 835, 836, 837, 838, 839, 840, 841, 842, 843, 844, 845, 846, 847, 848, 849, 850, 851, 852, 853, 854, 855, 856, 857, 858, 859, 860, 861, 862, 863, 864, 865, 866, 867, 868, 869, 870, 871, 872, 873, 874, 875, 876, 877, 878, 879, 880, 881, 882, 883, 884, 885, 886, 887, 888, 889, 890, 891, 892, 893, 894, 895, 896, 897, 898, 899, 900, 901, 902, 903, 904, 905, 906, 907, 908, 909, 910, 911, 912, 913, 914, 915, 916, 917, 918, 919, 920, 921, 922, 923, 924, 925, 926, 927, 928, 929, 930, 931, 932, 933, 934, 935, 936, 937, 938, 939, 940, 941, 942, 943, 944, 945, 946, 947, 948, 949, 950, 951, 952, 953, 954, 955, 956, 957, 958, 959, 960, 961, 962, 963, 964, 965, 966, 967, 968, 969, 970, 971, 972, 973, 974, 975, 976, 977, 978, 979, 980, 981, 982, 983, 984, 985, 986, 987, 988, 989, 990, 991, 992, 993, 994, 995, 996, 997, 998, 999, 1000

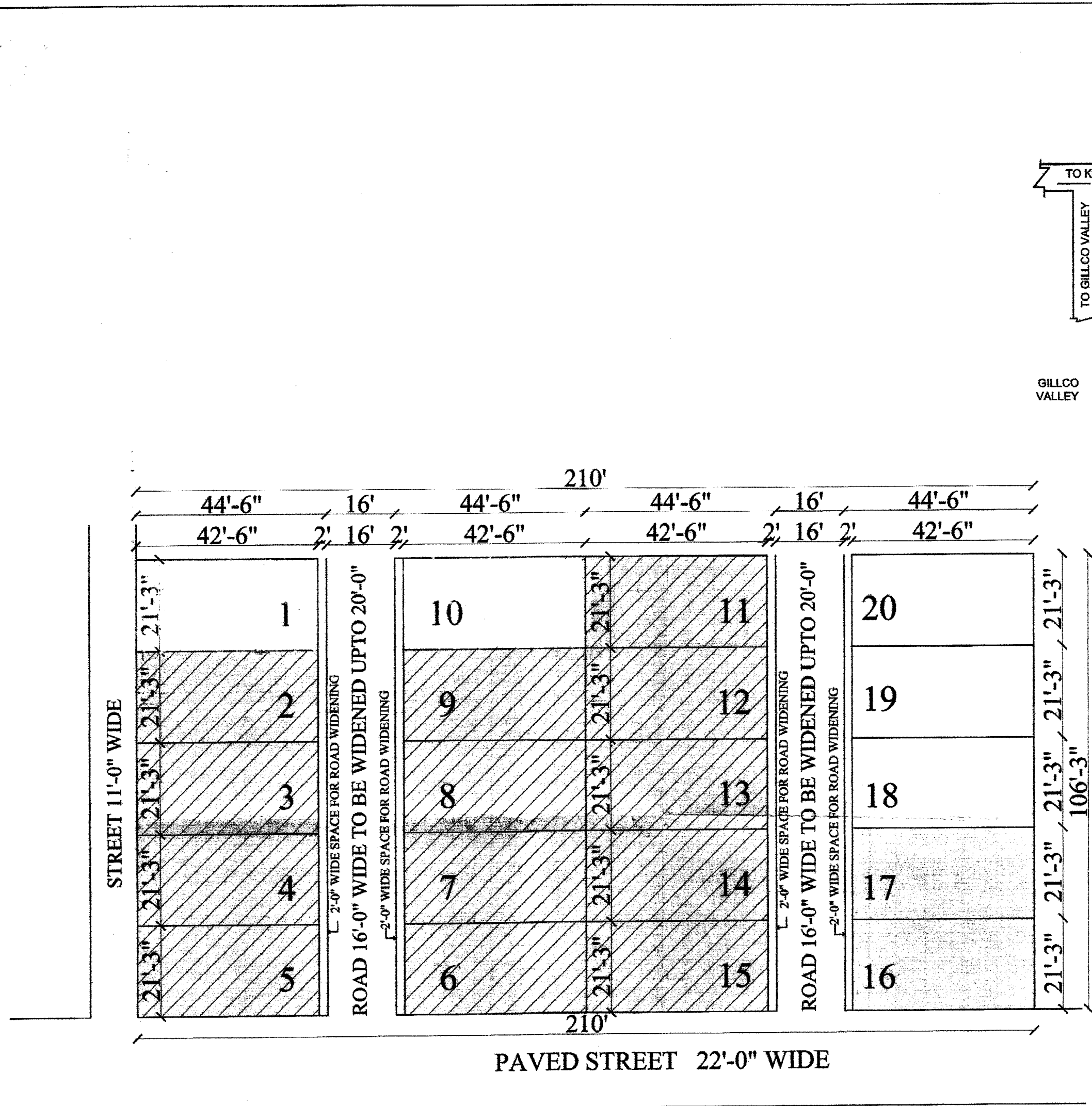

LAYOUT PLAN

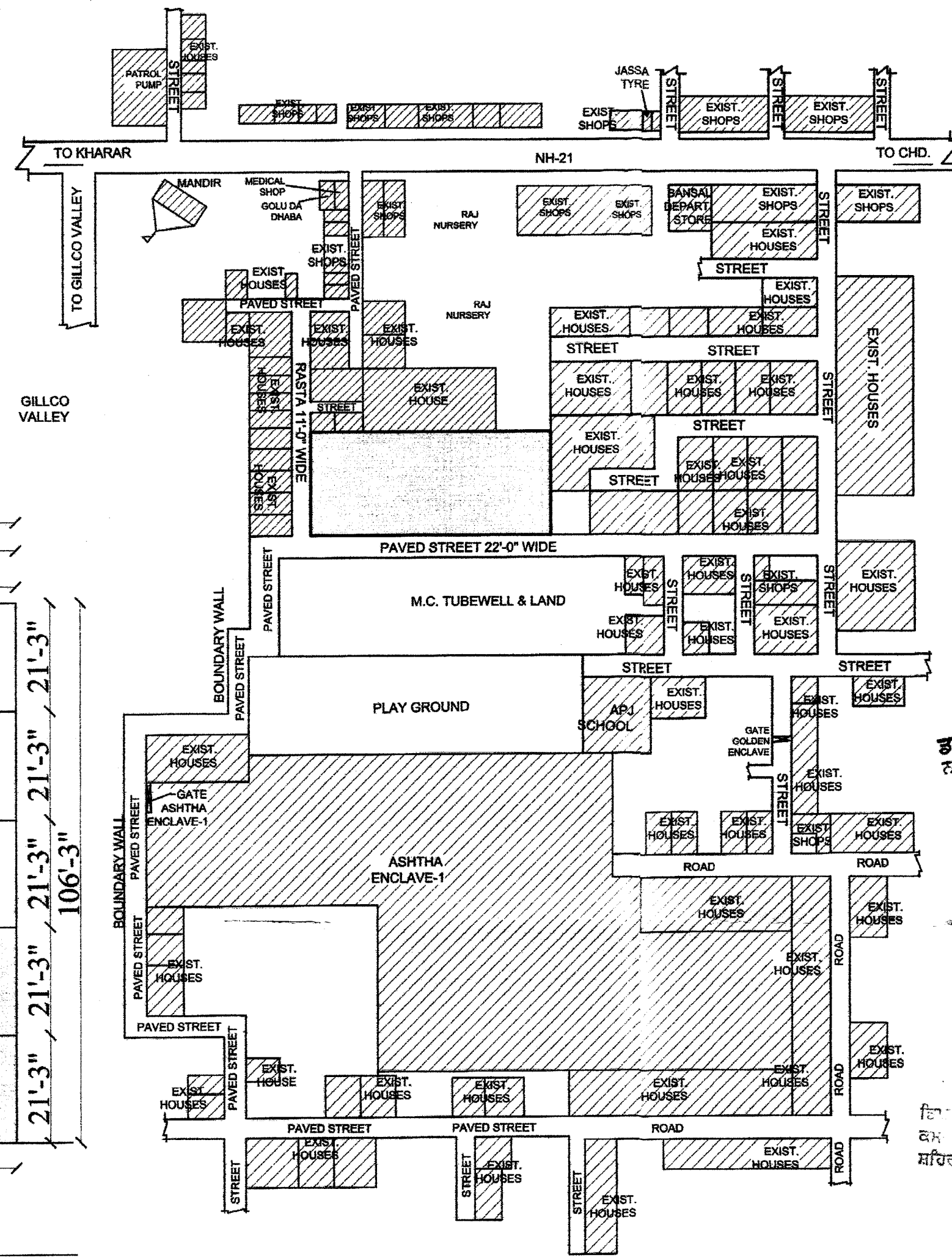

LOCATION PLAN

28